

IMPORTANT CHANGE TO SEVERE WEATHER PLANNING & COMMUNITY SHELTER LIST

(EFFECTIVE Tuesday, January 10, 2017)

The Cullman County Courthouse basement is NO LONGER designated as a “Community Shelter” for severe weather events.

The designated “Community Shelters” in the city of Cullman are located at:

1. 1511 Sportsman Lake Rd NW – across from the Cullman County Fairgrounds

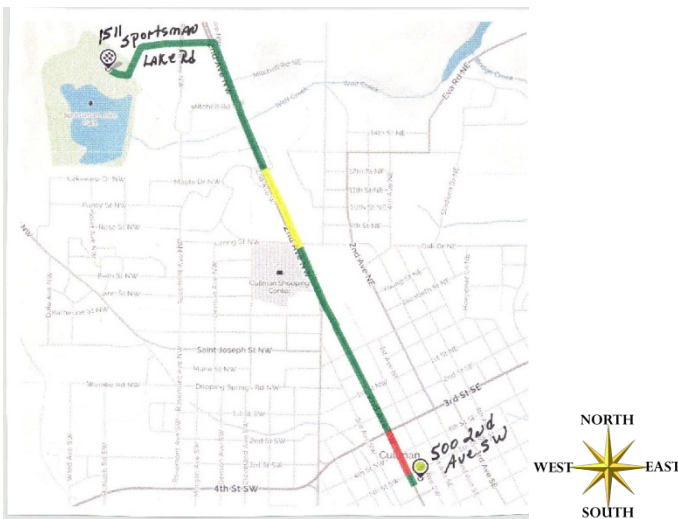

Driving Directions From Courthouse:
Take 2nd Ave/US Hwy 31 north approx. 2 miles to Sportsman Lake Rd. Turn left, shelter is located approx. 1 block from 2nd Ave on right.

Shelter capacity: 396+

2. CCCDD Beech Center (basement) – 1803 Beech Ave SE Cullman in Basement

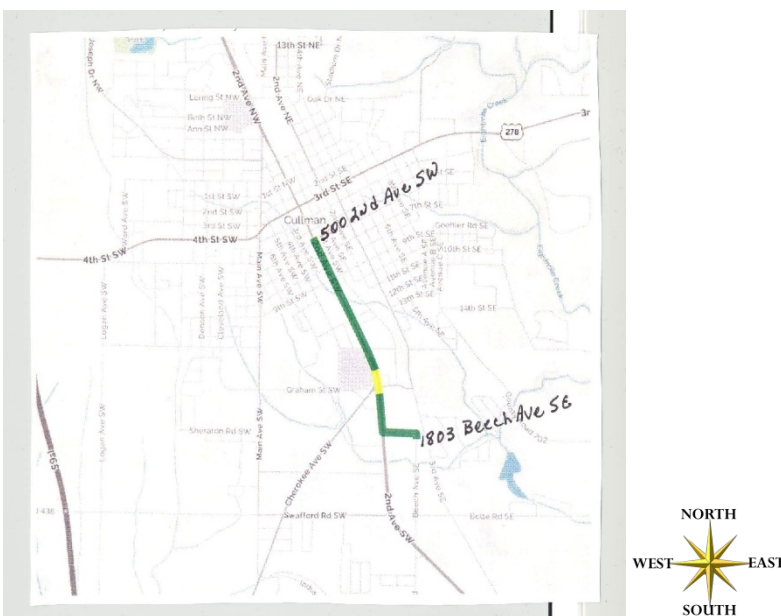

Driving Directions From Courthouse:
Take 2nd Ave/US Hwy 31 south approx. 1-1.5 miles past Walgreens to Sheraton Rd SE (Handy TV). Turn left, go under railroad tracks to Beech Ave SE. Turn right. Turn right into Beech Center parking lot. Entrance to shelter is through the Red Cross office in the basement.

Shelter Capacity: 150+